

**USO-USC-USP-USL**

**Fissacavi singoli per cavi coassiali**

**Versioni:**

- ① **USO** per piatto forato
- ② **USC** per piatto, tondo e angolare
- ③ **USP** per profilato **PCI 40x22**
- ④ **USL** per passerelle portacavi in filo d'acciaio

**Composizione:**

- 1 - Monosella calibrata **SAM** di H.D.P.E. rinforzato vetro
- 2 - Barra filettata - **BFI M8** (M10 a richiesta)
- 3 - Rondelle piatte **RPI 10/20**
- 4 - Dadi esagonali M8 UNI 5588
- 5 - Cerniera flessibile

**Impiego:**

Fissaggio 1 - 4 cavi coassiali.  
Fissaggio di guide d'onda mediante guarnizioni elastiche **GRE-GRQ**.

**Materiale:**

Acciaio INOX AISI 304.  
H.D.P.E. rinforzato con fibra di vetro, resistente a U.V.  
Colore: nero (grigio a richiesta).

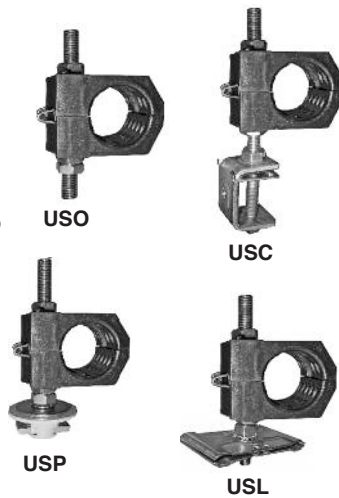

**USO-USC-USP-USL**

**Einzel-Schellen für Koaxialkabel**

**Versionen:**

- ① **USO** für gelochtes Flacheisen
- ② **USC** für Flach-, Rund-, Winkeleisen
- ③ **USP** für Profil **PCI 40x22**
- ④ **USL** für Gitterbahnen

**Zusammenbau:**

- 1 - **SAM** Einzel-Wanne aus glasf. verst. H.D.P.E.
- 2 - Gewindestange - **BFI M8** (M10 auf Anfrage)
- 3 - Unterlegscheiben **RPI 10/20**
- 4 - M8-Muttern UNI 5588
- 5 - Flexibles Scharniergelenk

**Einsatz:**

Befestigung von 1 - 4 Koaxialkabeln.  
Mittels elastischen Klemmprofilen **GRE-GRQ** auch von Wellenleitern.

**Material:**

Stahl AISI 304 (V2A).  
H.D.P.E. glasfaserverstärkt, U.V. - beständig.  
Farbe: schwarz (grau auf Anfrage).

**USO-USC-USP-USL**

**Single Clamps for Coaxial Cables**

**Versions:**

- ① **USO** for flat iron with holes
- ② **USC** for flat, round and corner
- ③ **USP** for **PCI 40x22** profile
- ④ **USL** for steel wire cable trays

**Components:**

- 1 - **SAM** single Saddle of glass reinf. H.D.P.E.
- 2 - Threaded Bar - **BFI M8** (M10 on request)
- 3 - **RPI 10/20** flat Washers
- 4 - Hexagon nuts UNI 5588
- 5 - Flexible Hinge

**Use:**

Fixing 1 to 4 coaxial cables.  
**GRE-GRQ** elastic cushions allow fastening of waveguides.

**Material:**

AISI 304 Stainless steel.  
Fiberglass reinforced H.D.P.E., U.V. proof.  
Colour: black (grey on request).

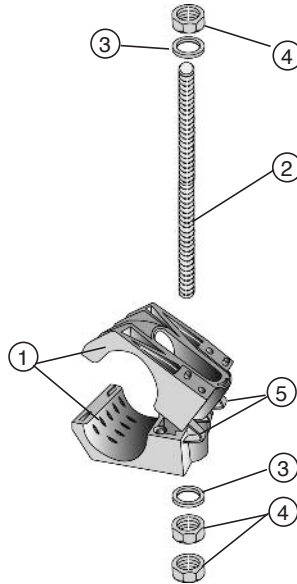

**USO-USC-USP-USL**

**Fixations simples pour câbles coaxiaux**

**Versions:**

- ① **USO** pour fer plat avec trous
- ② **USC** pour plat, rond et cornière
- ③ **USP** pour profilé **PCI 40x22**
- ④ **USL** pour structures en fil acier

**Composants:**

- 1 - Garniture simple **SAM** en H.D.P.E. chargé verre
- 2 - Tige filetée - **BFI M8** (M10 sur demande)
- 3 - Rondelles plates **RPI 10/20**
- 4 - Ecrous hexagonaux
- 5 - Charnière flexible

**Emploi:**

Fixation de 1 à 4 câbles coaxiaux.  
Fixation de guides d'onde par garnitures **GRE-GRQ**.

**Matériel:**

Inox AISI 304.  
H.D.P.E. chargé verre, résistant aux U.V.  
Couleur: noir (gris sur demande).

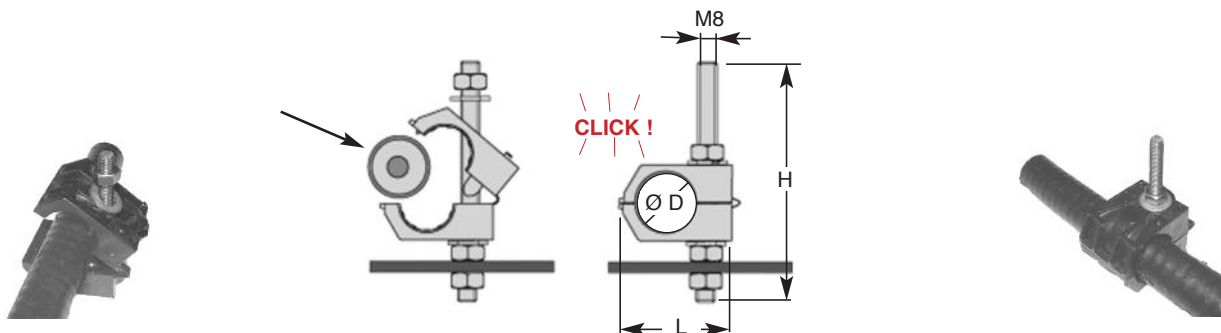

**SAM - Monoselle incernierate (brev.)**

Grazie alla dentellatura speciale interna fanno presa sul cavo coassiale senza comprimerlo né deformarlo. La chiusura della sella è calibrata sui diametri dei cavi coassiali.  
Una cerniera flessibile (brev.) consente l'apertura e la chiusura controllata dei due gusci

**Materiale:**

H.D.P.E. rinforzato con fibra di vetro.  
Resistente ai raggi U.V. (-50°C ÷ +80°C)  
Colore: nero (grigio a richiesta).



Cerniera flessibile (brev.)  
Flexible hinge (Pat.)  
Flexibles Scharniergelenk (Pat.)  
Charnière flexible (Brev.)

**SAM - Hinged Single Saddles (Pat.)**

The internal indentation allows gripping on the cable without compressing nor deforming it.  
The saddle size is calibrated and corresponds to the diameter of the coaxial cables.  
A flexible hinge (patented) allows a controlled opening and closing of the two shells

**Material:**

Fiberglass reinforced H.D.P.E.  
U.V. proof. (-50°C ÷ +80°C)  
Colour: black (grey on request).

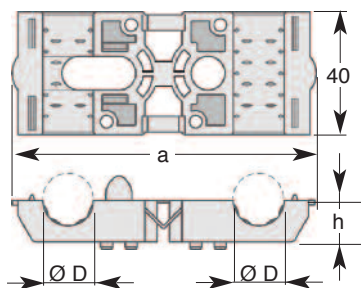

**SAM - Scharnier Einzel-Wannen (Pat.)**

Die Wannen entsprechen dem Standarddurchmesser der RF-Koaxialkabeln die formschlüssig eingebettet werden. Innenangebrachte Noppen haften am Kabelmantel ohne ihn zusammenzudrücken oder zu beschädigen. Ein flexibles Scharniergelenk (Pat.) erleichtert das Zusammenklappen der zwei Halbwannen

**Material:**

H.D.P.E. glasfaserverstärkt.  
U.V. beständig (-50°C ÷ +80°C)  
Farbe: schwarz (grau auf Anfrage).

**SAM - Garnitures pivotantes sur charnière (brev.)**

Elles sont calibrées pour le diamètre des câbles coaxiaux. Grâce aux dentelures intérieures elles fixent le câble sans le comprimer ni le déformer.  
Une charnière flexible (brev.) permet le contrôle de l'ouverture et de la fermeture des deux parties

**Matériel:**

H.D.P.E. renforcé fibre de verre.  
Résistant aux rayons U.V. (-50°C ÷ +80°C)  
Couleur: noir (gris sur demande).



Figura Figure Abbildung Figure	Codice Code Artikel Nr. Code	Articolo Article Artikel Article	a	L	Ø D	h	h1				Prezzo Price Preis Code
	61 3315 0011	<b>SAM/ 1x11</b>	92	44	10-11	10,5	21	20	500	16	
	61 3315 0014	<b>SAM/ 1x1/2" S (14)</b>	103	50	13-14	13,5	27	20	500	24	
	61 3315 0012	<b>SAM/ 1x1/2" (17)</b>	103	50	16-17	13,5	27	20	500	22	
	61 3315 0078	<b>SAM/ 1x7/8 (28)</b>	122	59	27-28	19	38	20	100	32	
	61 3315 0114	<b>SAM/ 1x1.1/4" (40)</b>	145	70	39-40	27	54	20	100	50	
	61 3315 0158	<b>SAM/ 1x1.5/8" (52)</b>	165	80	50-52	33	66	20	100	60	



**USO - Fissacavi per piatto forato**

Composizione:  
Sella **SAM** + perno filettato M8 + dadi + rondelle

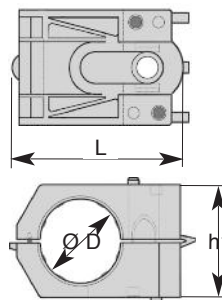
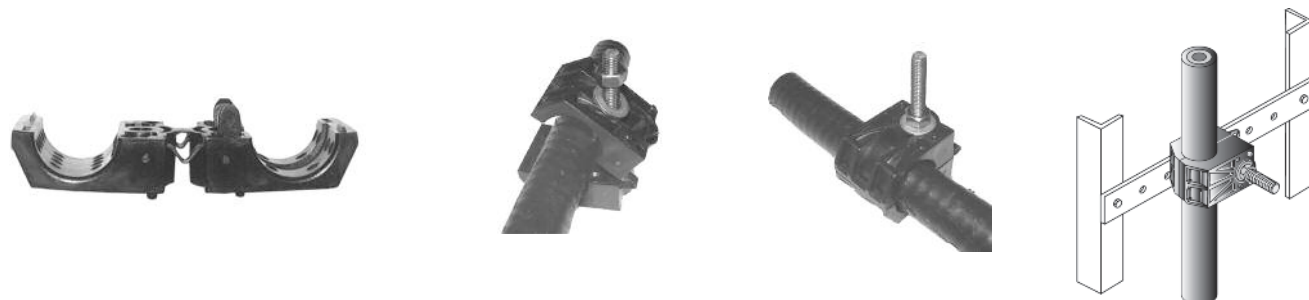

**USO - Kabelschellen für gelochtes Flacheisen**

Zusammenbau:  
**SAM** Wanne + Gewindest. M8 + Muttern + Scheiben

**USO - Cable Clamps for flat iron with holes**

Composition:  
**SAM** Saddle + M8 threaded bar + nuts + washers

**USO - Fixations pour fer plat avec trous**

Composition:  
Garniture **SAM** + tige fil. M8 + écrous + rondelles

Figura Figure Abbildung Figure	Codice Code Artikel Nr. Code	Articolo Article Artikel Article	ø D	H	h1	L			g 	Prezzo Price Preis Prix
<p>1 Cavo 1 Kabel</p> <p><b>USO/1</b></p>	61 1571 0011	<b>USO/ 1x11</b>	10-11	75	21	44			47	
	61 1571 0014	<b>USO/ 1x1/2" S (14)</b>	13-14	75	27	50			50	
	61 1571 0012	<b>USO/ 1x1/2" (17)</b>	16-17	75	27	50			50	
	61 1571 0078	<b>USO/ 1x7/8" (28)</b>	27-28	100	38	59			77	
	61 1571 0114	<b>USO/ 1x1.1/4" (40)</b>	39-40	100	54	70			100	
	61 1571 0158	<b>USO/ 1x1.5/8" (52)</b>	50-52	125	66	80			140	
<p>2 Cavi 2 Kabel</p> <p><b>USO/2</b></p>	61 1571 0211	<b>USO/ 2x11</b>	10-11	100	42	44			60	
	61 1571 0214	<b>USO/ 2x1/2" S (14)</b>	13-14	100	54	50			75	
	61 1571 0212	<b>USO/ 2x1/2" (17)</b>	16-17	100	54	50			75	
	61 1571 0278	<b>USO/ 2x7/8" (28)</b>	27-28	125	76	59			115	
	61 1571 2114	<b>USO/ 2x1.1/4" (40)</b>	39-40	200	108	70			145	
	61 1571 2158	<b>USO/ 2x1.5/8" (52)</b>	50-52	200	132	80			197	
<p>3 Cavi 3 Kabel</p> <p><b>USO/3</b></p>	61 1571 0311	<b>USO/ 3x11</b>	10-11	100	63	44			77	
	61 1571 0314	<b>USO/ 3x1/2" S (14)</b>	13-14	125	81	50			100	
	61 1571 0312	<b>USO/ 3x1/2" (17)</b>	16-17	125	81	50			100	
	61 1571 0378	<b>USO/ 3x7/8" (28)</b>	27-28	200	114	59			152	
	61 1571 3114	<b>USO/ 3x1.1/4" (40)</b>	39-40	250	150	70			190	
	61 1571 3158	<b>USO/ 3x1.5/8" (52)</b>	50-52	300	198	80			260	
<p>4 Cavi 4 Kabel</p> <p><b>USO/4</b></p>	61 1571 0411	<b>USO/ 4x11</b>	10-11	125	84	44			95	
	61 1571 0414	<b>USO/ 4x1/2" S (14)</b>	13-14	150	108	50			72	
	61 1571 0412	<b>USO/ 4x1/2" (17)</b>	16-17	150	108	50			72	
	61 1571 0478	<b>USO/ 4x7/8" (28)</b>	27-28	200	152	59			185	
	61 1571 4114	<b>USO/ 4x1.1/4" (40)</b>	39-40	300	216	70			235	
	61 1571 4158	<b>USO/ 4x1.5/8" (52)</b>	50-52	400	264	80			323	

Esempio di fissaggio piatti forati  
Fixings example on flat iron with holes

Befestigung-Beispiel an gelochtes Flacheisen  
Exemple de fixations sur fer plat avec trous

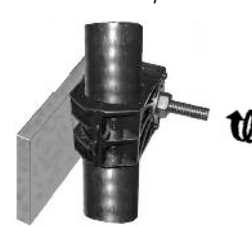
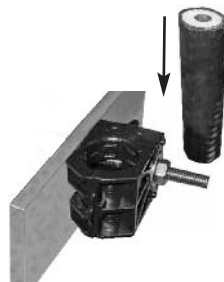

**SOLUZIONI**  
**PER L'INSTALLAZIONE**

**SOLUTIONS**  
**FOR INSTALLATIONS**



**LÖSUNGEN**  
**FÜR INSTALLATIONEN**

**SOLUTIONS**  
**POUR L'INSTALLATION**

**USC - Fissacavi per piatti, tondi e angolari**

Composizione:  
**USO + mini morsetto MIM 8**

**USC - Cable Clamps for flat, round and angular**

Composition:  
**USO + MIM 8 Mini Clamp**

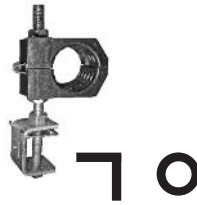

**USC - Kabelschellen für Flach, Rund, Winkeleisen**

Zusammenbau:  
**USO + Miniklemme MIM 8**

**USC - Fixations pour plat, rond et cornière**

Composition:  
**USO + mini fixation MIM 8**

Figura Figure Abbildung Figure	Codice Code Artikel Nr. Code	Articolo Article Artikel Article	ø D	H	h1	L			g	Prezzo Price Preis Prix
<p>1 Cavo 1 Kabel</p> <p><b>USC/1</b></p>	61 1572 0011	<b>USC/ 1x11</b>	10-11	75	21	44			102	
	61 1572 0014	<b>USC/ 1x1/2"S (14)</b>	13-14	75	27	50			105	
	61 1572 0012	<b>USC/ 1x1/2" (17)</b>	16-17	75	27	50			105	
	61 1572 0078	<b>USC/ 1x7/8" (28)</b>	27-28	100	38	59			132	
	61 1572 0114	<b>USC/ 1x1.1/4" (40)</b>	39-40	100	54	70			155	
	61 1572 0158	<b>USC/ 1x1.5/8" (52)</b>	50-52	125	66	80			155	
<p>2 Cavi 2 Kabel</p> <p><b>USC/2</b></p>	61 1572 0211	<b>USC/ 2x11</b>	10-11	100	42	44			115	
	61 1572 0214	<b>USC/ 2x1/2"S (14)</b>	13-14	100	54	50			130	
	61 1572 0212	<b>USC/ 2x1/2" (17)</b>	16-17	100	54	50			130	
	61 1572 0278	<b>USC/ 2x7/8" (28)</b>	27-28	125	76	59			170	
	61 1572 2114	<b>USC/ 2x1.1/4" (40)</b>	39-40	200	108	70			200	
	61 1572 2158	<b>USC/ 2x1.5/8" (52)</b>	50-52	200	132	80			200	
<p>3 Cavi 3 Kabel</p> <p><b>USC/3</b></p>	61 1572 0311	<b>USC/ 3x11</b>	10-11	100	63	44			132	
	61 1572 0314	<b>USC/ 3x1/2"S (14)</b>	13-14	125	81	50			155	
	61 1572 0312	<b>USC/ 3x1/2" (17)</b>	16-17	125	81	50			155	
	61 1572 0378	<b>USC/ 3x7/8" (28)</b>	27-28	200	114	59			207	
	61 1572 3114	<b>USC/ 3x1.1/4" (40)</b>	39-40	250	150	70			245	
	61 1572 3158	<b>USC/ 3x1.5/8" (52)</b>	50-52	300	198	80			290	
<p>4 Cavi 4 Kabel</p> <p><b>USC/4</b></p>	61 1572 0411	<b>USC/ 4x11</b>	10-11	125	84	44			150	
	61 1572 0414	<b>USC/ 4x1/2"S (14)</b>	13-14	150	108	50			127	
	61 1572 0412	<b>USC/ 4x1/2" (17)</b>	16-17	150	108	50			127	
	61 1572 0478	<b>USC/ 4x7/8" (28)</b>	27-28	200	152	59			240	
	61 1572 4114	<b>USC/ 4x1.1/4" (40)</b>	39-40	300	216	70			280	
	61 1572 4158	<b>USC/ 4x1.5/8" (52)</b>	50-52	400	264	80			325	

Esempio di fissaggio su angolare  
Fixings example on angular

Befestigung-Beispiel an Winkel Eisen  
Example de fixations sur cornière

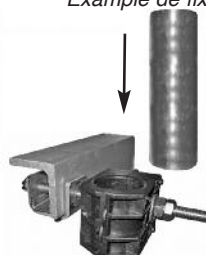
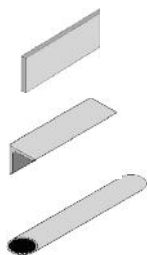

**SOLUZIONI**  
**PER L'INSTALLAZIONE**

**SOLUTIONS**  
**FOR INSTALLATIONS**



**LOSUNGEN**  
**FÜR INSTALLATIONEN**

**SOLUTIONS**  
**POUR L'INSTALLATION**

**USP - Fissacavi per profilato PCI 40x22**

Composizione:  
**USO + inserto scorrevole ISL 8**

**USP - Cable Clamps for PCI 40x22 section**

Composition:  
**USO + ISL 8 sliding Insert**



**USP - Kabelschellen für C-Profilschienen 40x22**

Zusammenbau:  
**USO + ISL 8 Schnellmontagemutter**

**USP - Fixations pour profilé PCI 40x22**

Composition:  
**USO + adaptateur rapide ISL 8**

Figura Figure Abbildung Figure	Codice Code Artikel Nr. Code	Articolo Article Artikel Article	ø D	H	h1	L		g	Prezzo Price Preis Prix
<p>1 Cavo 1 Kabel</p> <p><b>USP/1</b></p>	61 1573 0011	<b>USP/ 1x11</b>	10-11	75	21	44		72	
	61 1573 0014	<b>USP/ 1x1/2" S (14)</b>	13-14	75	27	50		75	
	61 1573 0012	<b>USP/ 1x1/2" (17)</b>	16-17	75	27	50		75	
	61 1573 0078	<b>USP/ 1x7/8" (28)</b>	27-28	100	38	59		102	
	61 1573 0114	<b>USP/ 1x1.1/4" (40)</b>	39-40	100	54	70		125	
	61 1573 0158	<b>USP/ 1x1.5/8" (52)</b>	50-52	125	66	80		165	
<p>2 Cavi 2 Kabel</p> <p><b>USP/2</b></p>	61 1573 0211	<b>USP/ 2x11</b>	10-11	100	42	44		85	
	61 1573 0214	<b>USP/ 2x1/2" S (14)</b>	13-14	100	54	50		95	
	61 1573 0212	<b>USP/ 2x1/2" (17)</b>	16-17	100	54	50		95	
	61 1573 0278	<b>USP/ 2x7/8" (28)</b>	27-28	125	76	59		140	
	61 1573 2114	<b>USP/ 2x1.1/4" (40)</b>	39-40	200	108	70		170	
	61 1573 2158	<b>USP/ 2x1.5/8" (52)</b>	50-52	200	132	80		222	
<p>3 Cavi 3 Kabel</p> <p><b>USP/3</b></p>	61 1573 0311	<b>USP/ 3x11</b>	10-11	100	63	44		102	
	61 1573 0314	<b>USP/ 3x1/2" S (14)</b>	13-14	125	81	50		125	
	61 1573 0312	<b>USP/ 3x1/2" (17)</b>	16-17	125	81	50		125	
	61 1573 0378	<b>USP/ 3x7/8" (28)</b>	27-28	200	114	59		175	
	61 1573 3114	<b>USP/ 3x1.1/4" (40)</b>	39-40	250	150	70		215	
	61 1573 3158	<b>USP/ 3x1.5/8" (52)</b>	50-52	300	198	80		275	
<p>4 Cavi 4 Kabel</p> <p><b>USP/4</b></p>	61 1573 0411	<b>USP/ 4x11</b>	10-11	125	84	44		120	
	61 1573 0414	<b>USP/ 4x1/2" S (14)</b>	13-14	150	108	50		97	
	61 1573 0412	<b>USP/ 4x1/2" (17)</b>	16-17	150	108	50		97	
	61 1573 0478	<b>USP/ 4x7/8" (28)</b>	27-28	200	152	59		210	
	61 1573 4114	<b>USP/ 4x1.1/4" (40)</b>	39-40	300	216	70		250	
	61 1573 4158	<b>USP/ 4x1.5/8" (52)</b>	50-52	400	264	80		310	

Esempio di fissaggio su profilati a "C"  
Fixings example on "C"-profiles

Befestigung-Beispiel an "C"-Profil  
Exemple de fixations sur profilé "C"

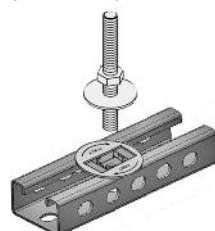
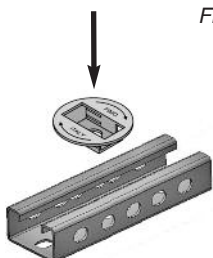

**SOLUZIONI**  
**PER L'INSTALLAZIONE**

**SOLUTIONS**  
**FOR INSTALLATIONS**



**LÖSUNGEN**  
**FÜR INSTALLATIONEN**

**SOLUTIONS**  
**POUR L'INSTALLATION**

**USL - Fissacavi per passerelle portacavi in filo**

Composizione:  
**USO + 2 piastre di spinta PUC 70**



**USL - Kabelschellen für Gitterbahnen**

Zusammenbau:  
**USO + 2 PUC 70 Druckplatte**

**USL - Cable Clamps for steel wire-mesh cable trays**

Composition:  
**USO + 2 PUC 70 steel pressure plates**

**USL - Fixations pour chemins de câble en treillis**

Composition:  
**USO + 2 plaques de compression PUC 70**

Figura Figure Abbildung Figure	Codice Code Artikel Nr. Code	Articolo Article Artikel Article	ø D	H	h1	L			g 	Prezzo Price Preis Prix
1 Cavo 1 Kabel   <b>USL/1</b>	61 1578 0011	<b>USL/ 1x11</b>	10-11	75	21	44	20		83	
	61 1578 0014	<b>USL/ 1x1/2"S (14)</b>	13-14	75	27	50	20		85	
	61 1578 0012	<b>USL/ 1x1/2" (17)</b>	16-17	75	27	50	20		85	
	61 1578 0078	<b>USL/ 1x7/8" (28)</b>	27-28	100	38	59	20		115	
	61 1578 0114	<b>USL/ 1x1.1/4" (40)</b>	39-40	100	54	70	20		144	
	61 1578 0158	<b>USL/ 1x1.5/8" (52)</b>	50-52	125	66	80	20		190	
2 Cavi 2 Kabel   <b>USL/2</b>	61 1578 0211	<b>USL/ 2x11</b>	10-11	100	42	44	20		98	
	61 1578 0214	<b>USL/ 2x1/2"S (14)</b>	13-14	100	54	50	20		110	
	61 1578 0212	<b>USL/ 2x1/2" (17)</b>	16-17	100	54	50	20		110	
	61 1578 0278	<b>USL/ 2x7/8" (28)</b>	27-28	125	76	59	20		160	
	61 1578 2114	<b>USL/ 2x1.1/4" (40)</b>	39-40	200	108	70	20		195	
	61 1578 2158	<b>USL/ 2x1.5/8" (52)</b>	50-52	200	132	80	20		255	
3 Cavi 3 Kabel   <b>USL/3</b>	61 1578 0311	<b>USL/ 3x11</b>	10-11	100	63	44	20		117	
	61 1578 0314	<b>USL/ 3x1/2"S (14)</b>	13-14	125	81	50	20		144	
	61 1578 0312	<b>USL/ 3x1/2" (17)</b>	16-17	125	81	50	20		144	
	61 1578 0378	<b>USL/ 3x7/8" (28)</b>	27-28	200	114	59	20		200	
	61 1578 3114	<b>USL/ 3x1.1/4" (40)</b>	39-40	250	150	70	20		248	
	61 1578 3158	<b>USL/ 3x1.5/8" (52)</b>	50-52	300	198	80	20		315	
4 Cavi 4 Kabel   <b>USL/4</b>	61 1578 0411	<b>USL/ 4x11</b>	10-11	125	84	44	20		140	
	61 1578 0414	<b>USL/ 4x1/2"S (14)</b>	13-14	150	108	50	20		112	
	61 1578 0412	<b>USL/ 4x1/2" (17)</b>	16-17	150	108	50	20		112	
	61 1578 0478	<b>USL/ 4x7/8" (28)</b>	27-28	200	152	59	20		240	
	61 1578 4114	<b>USL/ 4x1.1/4" (40)</b>	39-40	300	216	70	20		285	
	61 1578 4158	<b>USL/ 4x1.5/8" (52)</b>	50-52	400	264	80	20		356	

Esempio di fissaggio su passerelle fissacavi in filo d'acciaio  
*Fixings example on steel wire-mesh cable trays*

Befestigung-Beispiel für Gitterbahnen  
*Example de fixations sur chemins de câble en treillis*

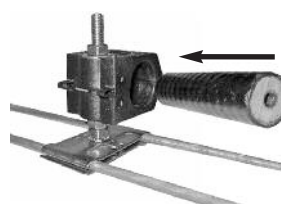











**SOLUZIONI**  
**PER L'INSTALLAZIONE**

**SOLUTIONS**  
**FOR INSTALLATIONS**

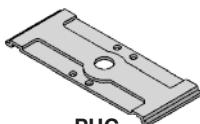

**LÖSUNGEN**  
**FÜR INSTALLATIONEN**

**SOLUTIONS**  
**POUR L'INSTALLATION**

Figura Figure Abbildung Figure	Codice Code Artikel Nr. Code	Articolo Article Artikel Article	Impiegabile con Suitable to Anwendbar mit Employable avec	Misura Mesure Abmessungen Taille				Prezzo Price Preis Prix
<p>Barra filettata M8 M8 Gewindestangen M8 Threaded bars Tiges filetées M8</p>  <p><b>BFI 8x..</b></p>	61 2954 8050	<b>BFI 8x 50</b>	<p>LCO - LCC - LCP - LCL UCO - UCC - UCP - UCL USO - USC - USP - USL SAB - SAC - SAL - SAM MCO - MCC - MCP - MCL</p>	M8 x 50	10	10	17	
	61 2954 8075	<b>BFI 8x 75</b>		M8 x 75	10	100	25	
	61 2954 8100	<b>BFI 8x 100</b>		M8 x 100	10	100	34	
	61 2954 8125	<b>BFI 8x 125</b>		M8 x 125	10	100	45	
	61 2954 8150	<b>BFI 8x 150</b>		M8 x 150	10	100	55	
	61 2954 8200	<b>BFI 8x 200</b>		M8 x 200	10	100	68	
	61 2954 8250	<b>BFI 8x 250</b>		M8 x 250	10	100	85	
	61 2954 8300	<b>BFI 8x 300</b>		M8 x 300	10	100	98	
	61 2954 8400	<b>BFI 8x 400</b>		M8 x 400	10	100	110	
	61 2954 8000	<b>BFI 8x1000</b>		M8 x1000	10	100	150	
<p>Barra filettata M10 M10 Gewindestangen M10 Threaded bars Tiges filetées M10</p>  <p><b>BFI 10x..</b></p>	61 2954 1050	<b>BFI 10x 50</b>	<p>LCO - LCC - LCP - LCL UCO - UCC - UCP - UCL USO - USC - USP - USL SAB - SAC - SAL - SAM MCO - MCC - MCP - MCL</p>	M10x 50	10	100	24	
	61 2954 1075	<b>BFI 10x 75</b>		M10x 75	10	100	40	
	61 2954 1100	<b>BFI 10x 100</b>		M10x 100	10	100	48	
	61 2954 1125	<b>BFI 10x 125</b>		M10x 125	10	100	60	
	61 2954 1150	<b>BFI 10x 150</b>		M10x 150	10	100	73	
	61 2954 1175	<b>BFI 10x 175</b>		M10x 175	10	100	85	
	61 2954 1200	<b>BFI 10x 200</b>		M10x 200	10	100	96	
	61 2954 1250	<b>BFI 10x 250</b>		M10x 250	10	100	122	
	61 2954 1300	<b>BFI 10x 300</b>		M10x 300	10	100	140	
	<p>Dado esagonale UNI 5588 6-Kant-Muttern UNI 5588 Hexagonal nuts UNI 5588 Ecroûes hexagonales UNI 5588</p>  <p><b>DAI..</b></p>	61 2918 2249		<b>DAI 8</b>	<p>LCO - LCC - LCP - LCL UCO - UCC - UCP - UCL USO - USC - USP - USL MCO - MCC - MCP - MCL</p>	M8	50	1000
61 2918 2251		<b>DAI 10</b>	M10	50		1000	10	
<p>Rondella piana Unterlegscheibe Flat washer Rondelle plate</p>  <p><b>RPL..</b></p>	61 2936 0008	<b>RPI 8/16</b>	<p>MCO - MCC - MCP - MCL UCP - LCP - MCP - USP USO - USC - USP - USL</p>	ø 8,5x16	50	1000	1.5	
	61 2936 0824	<b>RPI 8/24</b>		ø 8,5x24	50	1000	5.3	
	61 2936 0832	<b>RPI 8/32</b>		ø 8,5x32	50	1000	12	
	61 2936 1020	<b>RPI 10/20</b>		ø 10,5x20	50	1000	3	
	61 2936 1030	<b>RPI 10/30</b>		ø 10,5x30	50	1000	8	
<p>Rondella elastica DIN 6798 Sicherheitsscheiben DIN 6798 Elastic washer DIN 6798 Rondelle dentelées DIN 6798</p>  <p><b>REI..</b></p>	61 2917 0008	<b>REI 8</b>	<p>LCO - LCC - LCP - LCL UCO - UCC - UCP - UCL USO - USC - USP - USL</p>	ø 8x14	50	1000	0.6	
	61 2917 0010	<b>REI 10</b>		ø 10x16	50	1000	0.8	
<p>Piastra di spinta per selle <b>SAB</b> Druckplatte für Wannen <b>SAB</b> Pressure flange for <b>SAB</b> saddles Plaque pour garnitures <b>SAB</b></p>  <p><b>PUC..</b></p>	61 3228 0036	<b>PUC 36</b>	SAB 2x9 - SAB 2x11	40 x 36	20	100	12	
	61 3228 0049	<b>PUC 49</b>	SAB 2x13 - SAB 2x1/2" S - SAB 2x3/8" - SAB 2x1/2"	40 x 49	20	100	19	
	61 3228 0070	<b>PUC 70</b>	LCL - MCL - UCL - USL SAB 2x5/8" - SAB 2x7/8"	40 x 70	20	100	24	
	61 3228 0093	<b>PUC 93</b>	SAB 2x1.1/8" - SAB 2x1.1/4"	40 x 93	20	100	29	
	61 3228 0120	<b>PUC 120</b>	SAB 2x1.5/8"	40 x120	20	100	40	
<p>Piastra di spinta per selle <b>SAL</b> Druckplatte für Wannen <b>SAL</b> Pressure flange for <b>SAL</b> saddles Plaque pour garnitures <b>SAL</b></p>  <p><b>PSL..</b></p>	61 3229 4062	<b>PSL 62</b>	SAL 2x1/2"	40 x 62	20	100	24	
	61 3229 4084	<b>PSL 84</b>	SAL 2x7/8"	40 x 84	20	100	30	
	61 3229 4102	<b>PSL 102</b>	SAL 2x1.1/4"	40 x102	20	100	38	
	61 3229 4119	<b>PSL 119</b>	SAL 2x1.5/8"	40 x119	20	100	44	